

netatmo  
BY  
STARCK®

1

Replacing a wall-mounted thermostat



*You can watch this installation at:*  
<http://netatmo.com/video1>

Warning

## Warning!

- Read these instructions carefully before starting the installation.
- The Netatmo Thermostat must be installed according to applicable standards.
- Before any intervention, make sure power is turned off.

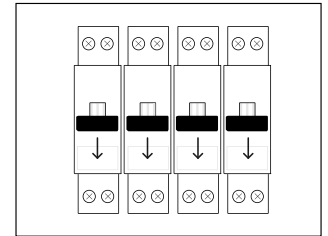
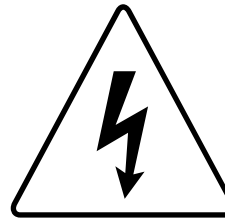

## In the box

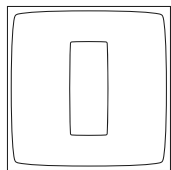

Thermostat

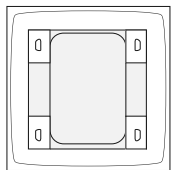

(Mobile stand)\*

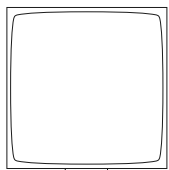

Relay

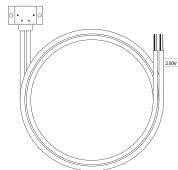

(Boiler adapter)\*



Mounting Plate

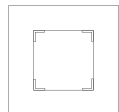

Trim plate

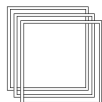

Color Adhesives



Mains adapter



(Tape)\*



3 AAA batteries



4 screws  
4 screw anchors



1 USB cable

## Relay

①

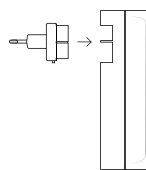

Plug the **mains adapter** into the **Relay**.

②

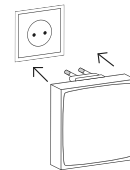

Plug the **Relay** into a wall socket in the same room as your existing thermostat.

③

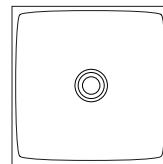

The **Relay** will blink white.

④

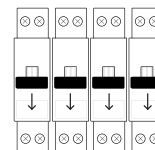

Switch off the power supply.

*\* not used in this setup*

## Identify

①

Remove the cover of your old thermostat.

Take a picture of the wiring.

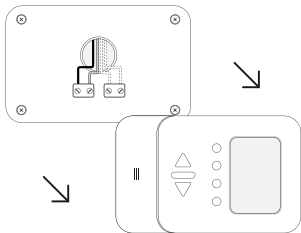

②

- If there are only two wires, they are the control wires and are useful in this setup.  
- If there are more than two wires, identify the two control wires. They are usually black or grey.

The wires can be identified as shown on the following diagram

*Note: If there are more than two wires, the others are power supply wires and are useless here. They are usually brown, blue, green or yellow.*

*In doubt, please send a picture to [photo@netatmo.com](mailto:photo@netatmo.com) and our support team will help you identify the right wires*

**Control wires**  
Usually black  
or grey wires

**Power supply wires**  
Usually blue and  
brown wires

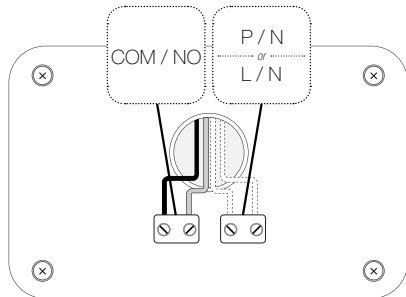

## Replace

①

Disconnect your old thermostat.  
Remove it from the wall.

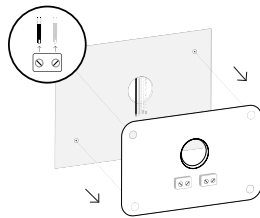

③

Pass the wires through the Netatmo **mounting plate** and screw the latter to the wall. To hide potential scratches and holes left behind, use the **trim plate**.

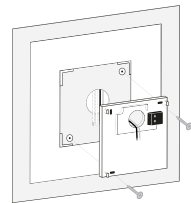

④

Screw the control wires previously identified into the electrical terminals and insulate the unused wires.  
Place and screw the **protection cover** onto the electrical terminals.

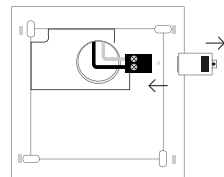

## Customisation

- ① You can choose to customize your **Thermostat** by using one of the **colour adhesives**.

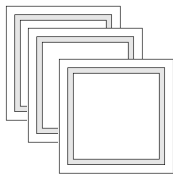

- ② Take off the outer frame of the **adhesive**.

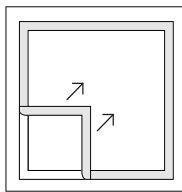

- ③ Stick it on the back of your **Thermostat**.

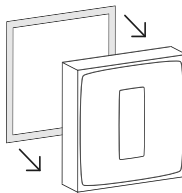

## Thermostat

- ① Insert the batteries in the **Thermostat**.

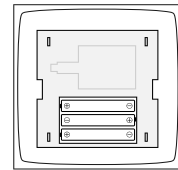

- ② Set the **Thermostat** on the **mounting plate**.

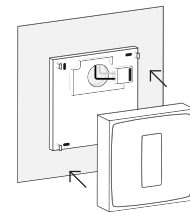

- ③ Switch the power supply back on.

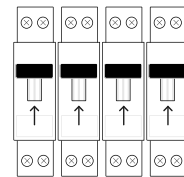

## Thermostat

The **Thermostat** will display the start screen and search for the **Relay**.

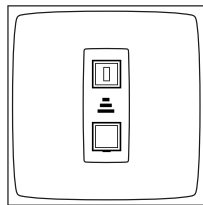

Desired temperature

Measured temperature

or  
.....  
.....

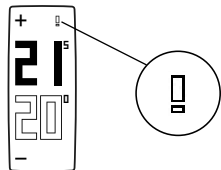

If the **Thermostat** has found the **Relay**, it displays the desired temperature and the room temperature.

If the **Thermostat** hasn't found the **Relay**, it displays the «!» symbol. In this case, move the **relay** closer to the **Thermostat** and wait until the «!» symbol disappears.

## Test

①

Push the top of the **Thermostat** until it displays « MAX ».

The **Thermostat** switches the boiler on.

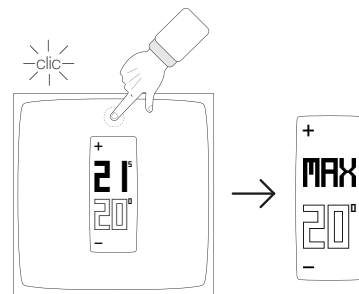

②

Push the bottom of the **Thermostat** until it displays « OFF ».

The **Thermostat** switches the boiler off.

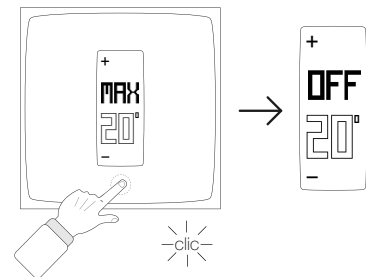

*Note: If the Thermostat doesn't switch on and off the boiler, the control wires have been incorrectly wired. In this case, check your wiring using the picture of your old thermostat's wiring to identify the right control wires. If the boiler does the opposite of what is described (for example, it switches OFF when the Thermostat displays MAX), it means that you will have to change the polarity of the Thermostat. You can modify the polarity in the advanced settings of the app once you will have finished the setup.*

## App

## Specifications

To use your Thermostat from your smartphone, tablet or computer, visit:

<http://therm.netatmo.com>



PC / Mac



Smartphone / Tablettes

### SIZE

Thermostat: 83 x 83 x 22 mm

### DESIGN

Designed by Starck.

Translucent minimalist plexiglass cube.  
5 interchangeable colours in the box.

### SENSORS AND MEASUREMENTS

Temperature (measurement):

Ranges from : 0°C à 50°C

Accuracy: -/+ 0,1°C

Temperature (setpoint):

Ranges from: 5°C à 30°C

Incrément: 0.5°C

Unit: °C

### E-INK DISPLAY

Energy efficient, longer battery life and optimal readability.

### FREE APP, LIFETIME SUPPORT

No subscription fee.

App available on the App Store, Windows Phone Store and on Google Play.

Free access to your online personal dashboard.

Accessible from multiple devices.

### WIRELESS SPECIFICATIONS

Wi-Fi 802.11 b/g/n compatible (2.4GHz).

Supported security: Open/WEP/WPA/WPA2-personal (TKIP and AES).

Wireless connection between thermostat and relay: radio long range 100 m.

### POWER AND BATTERIES

3 AAA batteries.

2 years battery life.

### SETUP AND COMPATIBILITY

Compatible with gas, fuel, wood boilers and heat pumps.

Switching current: max 4 A

Switching voltage: max 250 VAC

Switching power: max 120 W

### HOMEKIT

Controlling HomeKit-enabled accessories away from home requires an Apple TV (3rd generation or later) with Apple TV software 7.0 or later and an iPhone, iPad, or iPod touch with iOS 8.1 or later.





## EU Declaration of Conformity

We, Netatmo, declare that this device is in compliance with the essential requirements and other relevant provisions of Directive 1999/5/EC.

### Safety warnings

This device must be installed according to the applicable norms. Use only with supplied power plug adaptor and boiler adaptor. This device is for indoor use only.

Before inserting the batteries, check that the contacts in the device and on the batteries are clean, is necessary clean them. Note the polarity (+/-) when inserting the batteries. Do not throw the batteries into a fire, short-circuit them or dismantle them. Keep children away from batteries. Seek medical attention immediately if a battery is swallowed. Do not attempt to repair the device yourself; customer service is available. Any changes or modifications to this unit not expressly approved by the party responsible for compliance could void the user's authority

to operate the equipment. Thermostat and relay insulation: class II devices. This device is not intended for use by persons (including children) with reduced physical, sensory or mental capabilities, or lack of experience and knowledge, unless they have been given supervision or instruction concerning use of the appliance by a person responsible for their safety.

Children should be supervised to ensure that they do not play with the appliance.

### Legal notice

Use of the HomeKit logo means that an electronic accessory has been designed to connect specifically to iPod, iPhone, or iPad, respectively, and has been certified by the developer to meet Apple performance standards. Apple is not responsible for the operation of this device or its compliance with safety and regulatory standards.

Please note that the use of this accessory with iPod, iPhone, or iPad may affect wireless performance.



<http://support.netatmo.com>



netatmo  
BY  
STARCK®

2

Replacing a wireless thermostat



*You can watch this installation at:*  
<http://netatmo.com/video2>

or installing your first thermostat



*You can watch this installation at:*  
<http://netatmo.com/video3>

Warning

In the box

## Warning!

- Read these instructions carefully before starting the installation.
- The Netatmo Thermostat must be installed according to applicable standards.
- Before any intervention, make sure power is turned off.

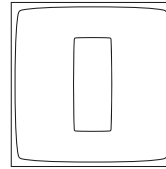
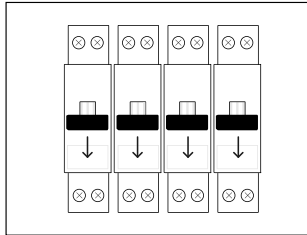
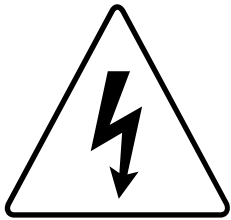

Thermostat

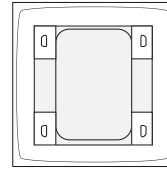

Mobile stand

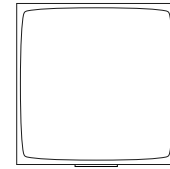

Relay

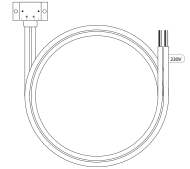

Boiler adapter



(Mounting Plate)\*

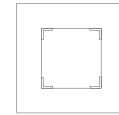

(Trim plate)\*

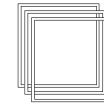

Color Adhesives

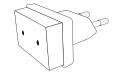

(Mains adapter)\*



Tape



3 AAA batteries



4 screws  
4 screw anchors

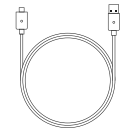

1 USB cable

\* not used or optional in this setup

## Wiring

Open the boiler door (use the boiler manual, if necessary).

Identify the thermostat terminals in the boiler, often labeled LS-LR, TA or COM-NO. They may be identifiable thanks to a shunt between the two thermostat terminals.

If you are replacing a wireless thermostat, find your former thermostat's relay and remove it.

If you are installing your first thermostat, please remove the shunt between the two thermostat terminals.

Connect the **black and grey wires of the boiler adapter cable** to the thermostat terminals.

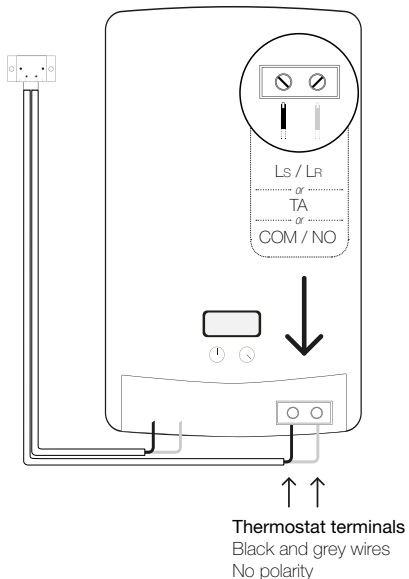

## Wiring

Connect the blue and brown wires of the **boiler adapter cable** to the power supply terminals (P/N or L/N).

Our forum can help you identify where to plug the wires in, at [forum.netatmo.com](http://forum.netatmo.com).

In doubt, please send a picture of your wiring to: [photo@netatmo.com](mailto:photo@netatmo.com) and our support team will help you identify the right terminals.

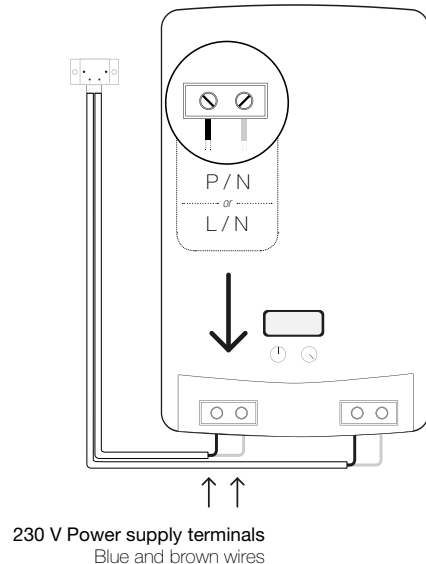

*Note : Some thermostats are connected to different terminals from those on the diagram's list (for example, eBus, EMS...). In this case, you will have to identify the right thermostat terminals to connect the Relay of the Netatmo Thermostat.*

## Setting the Relay

The **boiler adapter** should be placed as far as possible from metallic items (wiring, pipes, electrical grid...).

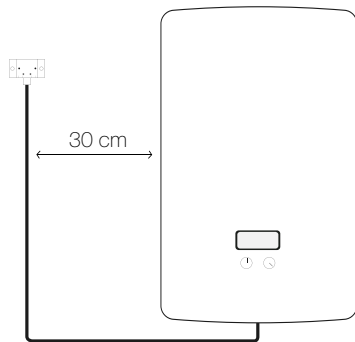

The **boiler adapter** can be affixed to the wall with the double-sided tape or the screws provided.

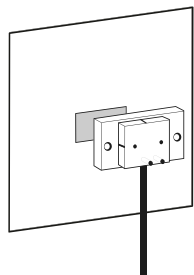

.....  
or  
.....

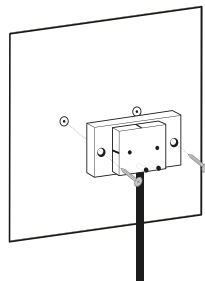

## Testing the Relay

① Connect the **Relay** into the **boiler adapter**.

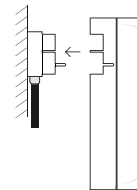

② Switch the power supply back on.

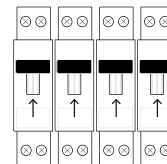

③ The **Relay** will blink white.

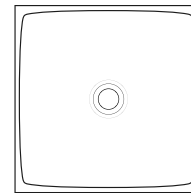

*Note* : If the **Relay** does not blink after turning the power back on, it is not power supplied. Please check how the blue and brown wires are wired. Do not forget to switch off the power supply before any intervention.

## Testing the Relay

①

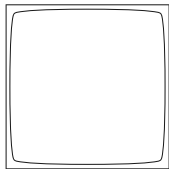

Push the **Relay** button.

②

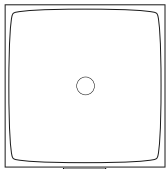

The **Relay** will light up white and switch on the boiler.

③

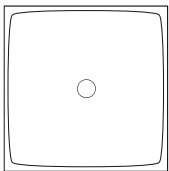

Push the **Relay** button again.

④

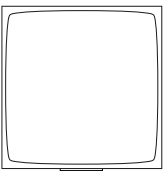

The **Relay** light will turn off to indicate the boiler is off.

## Thermostat

①

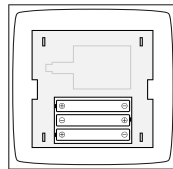

Insert the batteries into the **Thermostat**.

②

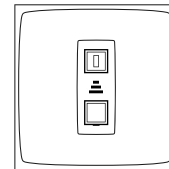

The **Thermostat** will display the start screen and search for the **Relay**.



Desired temperature

Measured temperature

OR



If the **Thermostat** has found the **Relay**, it will display the setpoint and the room temperatures.

If the **Thermostat** hasn't found the **Relay**, it will display the «!» symbol. In this case, move the **Relay** closer to the **Thermostat** and wait until the «!» symbol disappears.

***Note:** If the boiler doesn't switch on when the white light is on, the **Relay** can be incorrectly wired to the boiler. In this case, check where the grey and black wires are connected. Please note that some boilers can take up to 20 minutes to respond after pushing the Relay's button. In doubt, please read in your boiler's instructions manual [ the «room thermostat» section].*

## Customization

- ① You can choose to customize your **Thermostat** by using one of the **colour adhesives**.

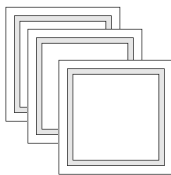

- ② Take off the outer frame of the **adhesive**.

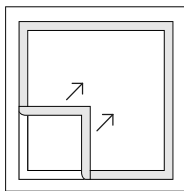

- ③ Stick it on the back of your **Thermostat**.

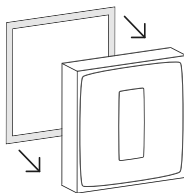

## Location

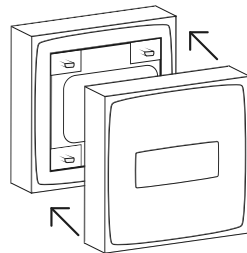

Clip the **Thermostat** on its **mobile stand** and place it on a shelf in the living room.

.....  
Or  
.....

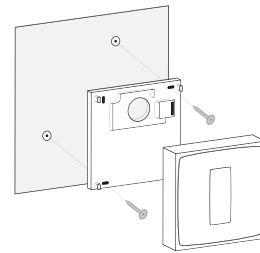

Set the **Thermostat** on the **mounting plate**.

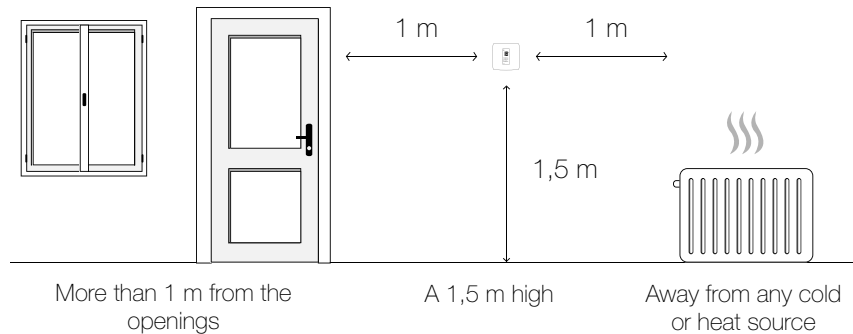

Test

App

①

Tap the top of the **Thermostat** until the screen shows « MAX ».

The **Thermostat** will switch on the boiler.

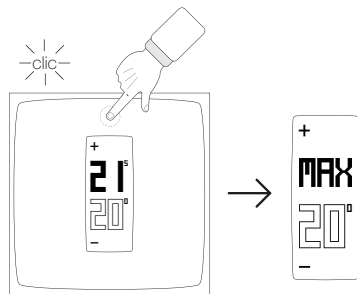

②

Tap the bottom of the **Thermostat** until it displays « OFF ».

The **Thermostat** will switch off the boiler.

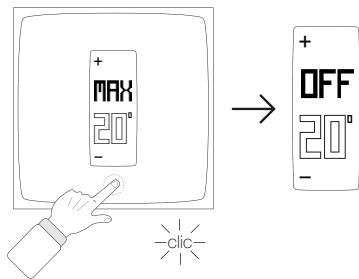

To use your Thermostat from your smartphone, tablet or computer, visit:

<http://therm.netatmo.com>



PC / Mac



Smartphone / Tablettes

*Note: If the boiler does the opposite of what is described (for example, it switches OFF when the Thermostat displays MAX), it means that you will have to change the polarity of the Thermostat. You can modify the polarity in the advanced settings of the app once you will have finished the setup.*



# Specifications

## SIZE

Thermostat: 83 x 83 x 22 mm

## DESIGN

Designed by Starck.

Translucent minimalist plexiglass cube.  
5 interchangeable colours in the box.

## SENSORS AND MEASUREMENTS

Temperature (measurement):

Ranges from : 0°C to 50°C

Accuracy:  $\pm 0,1^{\circ}\text{C}$

Temperature (setpoint):

Ranges from: 5°C to 30°C

Increment: 0.5°C

Unit: °C

## E-INK DISPLAY

Energy efficient, longer battery life and optimal readability.

## FREE APP, LIFETIME SUPPORT

No subscription fee.

App available on the App Store,  
Windows Phone Store and on  
Google Play.

Free access to your online personal  
dashboard.

Accessible from multiple devices.

## WIRELESS SPECIFICATIONS

Wi-Fi 802.11 b/g/n compatible (2.4GHz).

Supported security: Open/WEP/WPA/  
WPA2-personal (TKIP and AES).

Wireless connection between thermostat and relay:  
radio long range up to 100 m.

## POWER AND BATTERIES

3 AAA batteries.

2 years battery life.

## SETUP AND COMPATIBILITY

Compatible with gas, fuel, wood boilers  
and heat pumps.

Switching current: max 4 A

Switching voltage: max 250 VAC

Switching power: max 120 W

## HOMEKIT

Controlling HomeKit-enabled accessories away  
from home requires an Apple TV (3rd generation  
or later) with Apple TV software 7.0 or later and an  
iPhone, iPad, or iPod touch with iOS 8.1 or later.

## EU Declaration of Conformity

We, Netatmo, declare that this device is in compliance with the essential requirements and other relevant provisions of Directive 1999/5/EC.

### Safety warnings

This device must be installed according to the applicable norms. Use only with supplied power plug adaptor and boiler adaptor. This device is for indoor use only.

Before inserting the batteries, check that the contacts in the device and on the batteries are clean, is necessary clean them. Note the polarity (+/-) when inserting the batteries. Do not throw the batteries into a fire, short-circuit them or dismantle them. Keep children away from batteries. Seek medical attention immediately if a battery is swallowed. Do not attempt to repair the device yourself; customer service is available. Any changes or modifications to this unit not expressly approved by the party responsible for compliance could void the user's authority

to operate the equipment. Thermostat and relay insulation: class II devices. This device is not intended for use by persons (including children) with reduced physical, sensory or mental capabilities, or lack of experience and knowledge, unless they have been given supervision or instruction concerning use of the appliance by a person responsible for their safety.

Children should be supervised to ensure that they do not play with the appliance.

### Legal notice

Use of the HomeKit logo means that an electronic accessory has been designed to connect specifically to iPod, iPhone, or iPad, respectively, and has been certified by the developer to meet Apple performance standards. Apple is not responsible for the operation of this device or its compliance with safety and regulatory standards.

Please note that the use of this accessory with iPod, iPhone, or iPad may affect wireless performance.



<http://support.netatmo.com>

